

Holmen Business Park

Holmen, WI

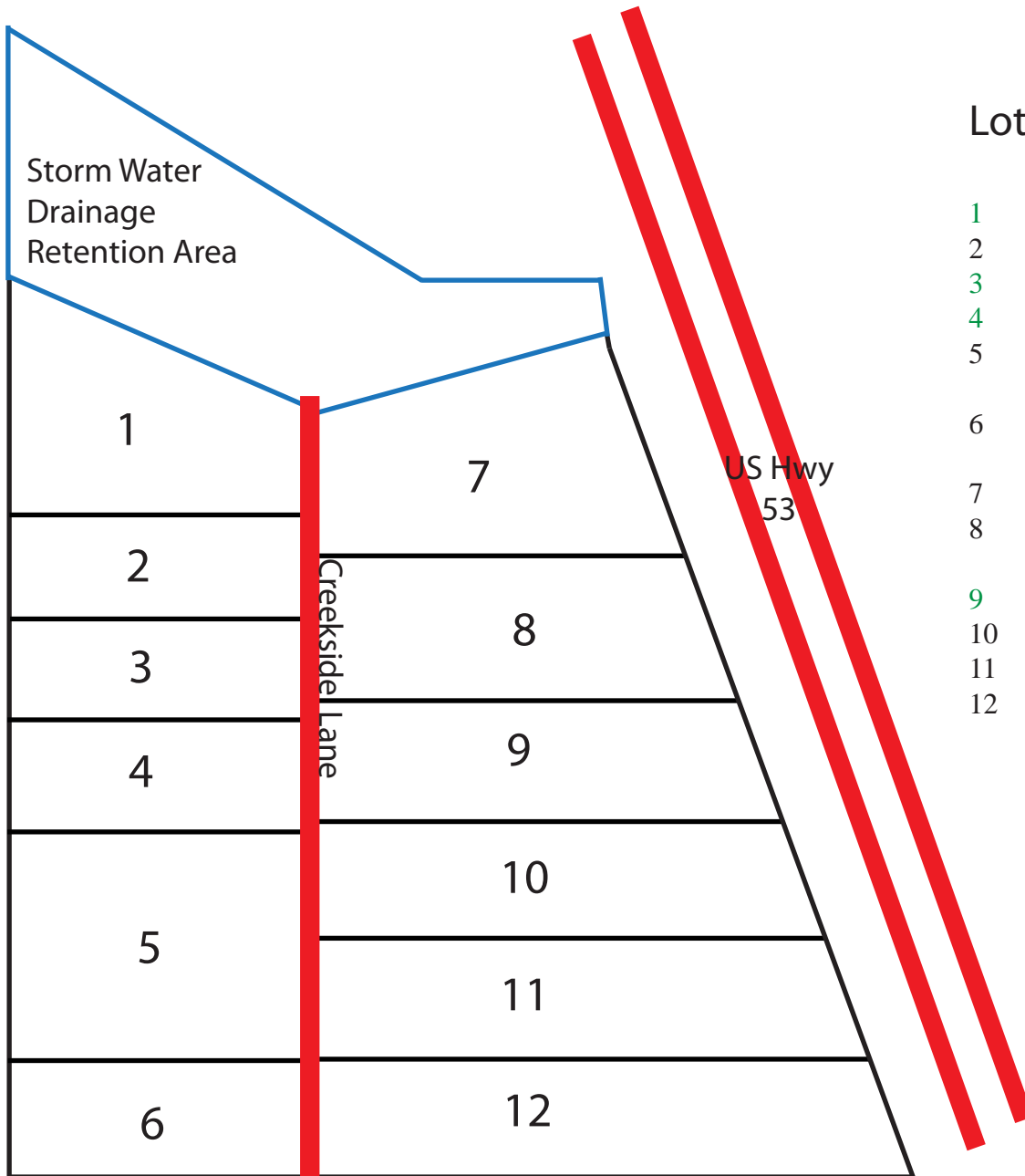

Lot Company

Lot	Company
1	Empty
2	Barge Professional Building
3	Empty
4	Empty
5	Department of Admin-Safety and Buildings
6	Engineering Testing & Gross Automation
7	Cedarwood Daycare
8	Better Living Home Improvements
9	Empty
10	Nesnah Ventures
11	MBA Architects
12	Borton Construction

Circle Drive Commercial Development
(See Cedar Creek Business Park)



For Additional Information Contact:
La Crosse Area Development Corporation
Ph: 608-784-5488
Email: ladco@centurytel.net

Village of Holmen
608-526-4336
www.holmenwi.com